



## Gibbon Lane, Plymouth

### 6 Bedroom Student Property

FROM  
**£130.00**  
PPPW inc. bills



#### PL4, GIBBON LANE

TOTAL FLOOR AREA: 1702 sq.ft. (158.1 sq.m.) approx.

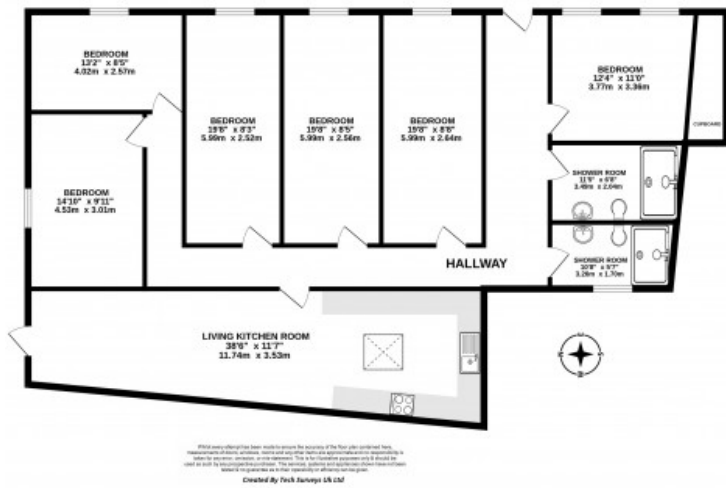

Brilliantly central, light and airy six-bedroom, end-terrace bungalow. This property has six evenly sized, recently decorated bedrooms, and a large, modern living room and kitchen.

This property is a two-minute walk from the university. With no-one above, and no immediate neighbours, this property is ideal for either those seeking peace and quiet, or anyone that tends to make a bit more noise themselves!

#### Room Availability

Room #1	£130.00 PPPW inc. bills
Room #2	£130.00 PPPW inc. bills
Room #3	£130.00 PPPW inc. bills
Room #4	£130.00 PPPW inc. bills
Room #5	£130.00 PPPW inc. bills
Room #6	£130.00 PPPW inc. bills

[www.plymouthstudentaccommodation.com](http://www.plymouthstudentaccommodation.com)



A Home After Halls, 11-12 Gibbon Lane, Plymouth, Devon, PL4 8BR  
contact@ahahlets.co.uk

**01752 600 485**